

Comprehensive pipeline systems

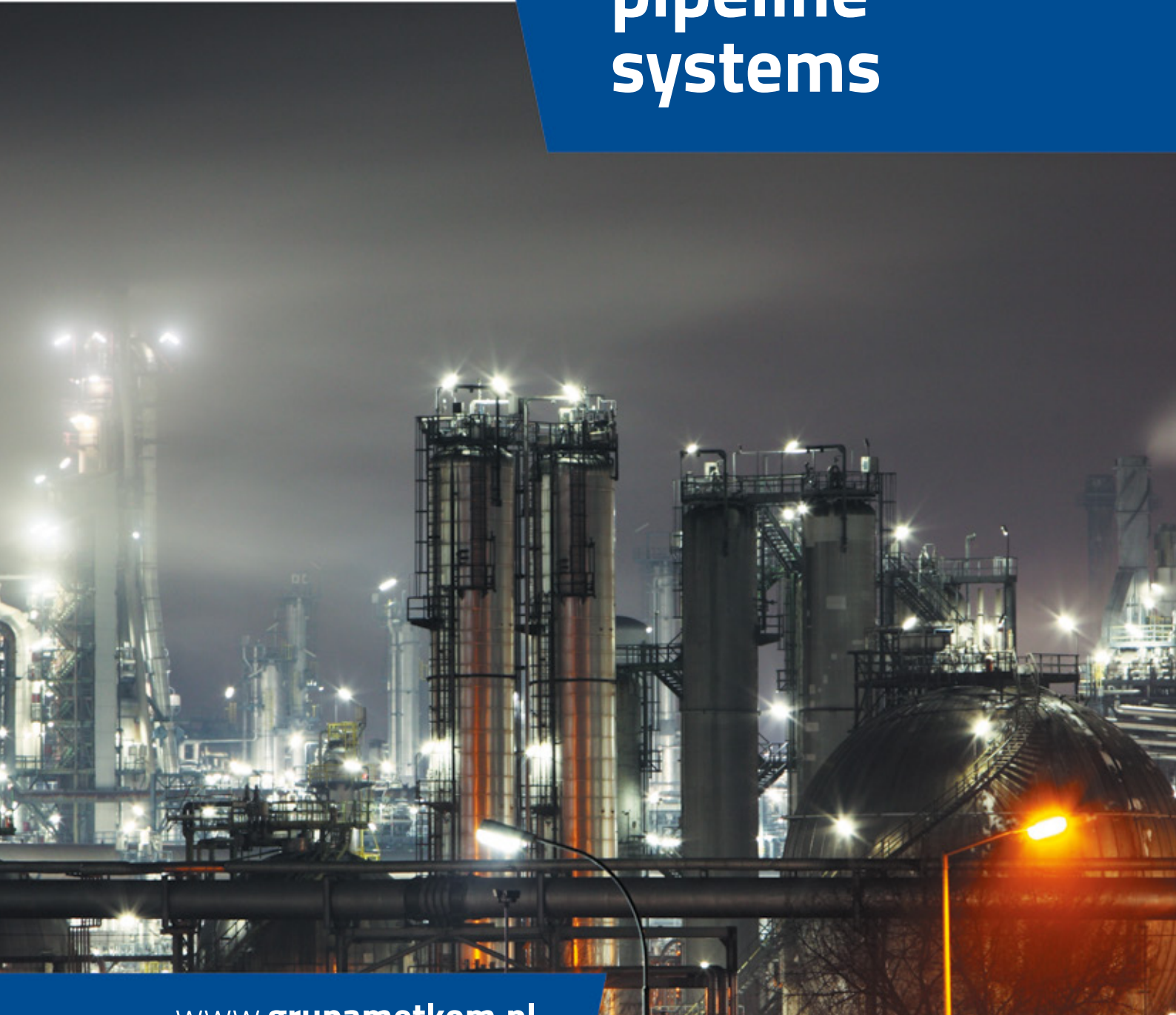

www.grupametkom.pl

About the company

Thanks to hard work and constant development, we are in significant position among suppliers in gas, energy and fuel industry.

We specialize in the delivery of comprehensive solutions for construction of industrial pipeline systems and industrial fittings. We offer products for pipelines transporting water systems, industrial liquids (including the aggressive ones) and gases. Our solutions and products are applied in mains, distribution and service lines, from the media source to places of their usage.

We put a client and his needs in the first place. We have been building confidence for years, providing high quality products and services.

We provide:

- » a wide storage range, available off-the-shelf
- » completion of "ad-hoc" and customised orders
- » production department completing individual orders efficiently
- » completion of deliveries, required documentation and certificates (3.1, 3.2)
- » realization of additional tests
- » own transport and developed logistic network
- » modern machine and research-measurement park

METKOM
GROUP



Office – Warszawice, Poland

High quality, safety, individual approach

METKOM Group

The capital group that has been acting in industrial market, consisting of three specialized companies:



Metkom Group warehouse-production complex

Valued competence

High competence and complementary offer cause that we are a regarded partner for executive companies in the scope of pipeline systems. Over 3000 clients from all over Poland have placed their trust in our company. We are also valued abroad. We have initiated cooperation with 270 foreign contractors from 26 countries (e.g. Germany, Italy, Czech Republic, Slovakia, Great Britain, Denmark, Lithuania, Estonia, Hungary, Serbia, Bulgaria). Opening the branch in Slovakia in 2016, was another development stage in our export activity.

Quality

We guarantee high quality, safety, individual approach and deliveries on time. Since 2010, we have implemented ISO 9001:2008 quality management system and numerous certificates (e.g. compliance with PED 2014/68/EU Directive or a welding certificate in conformity with the EN 3834-2 standard).

A wide group of satisfied clients is the best example that METKOM Group makes correct decisions supported by knowledge or qualifications.

A complementary offer

Our offer includes over 30 000 products made of materials available all over the world. It enables us to prepare individual solutions for many technologically advanced projects, carried out in various industrial branches. Concentrating on our clients' needs, we deliver also solutions produced in our factory in small series or per item in accordance with technical drawing delivered by clients.



Base

We have a 700m2 production hall at our disposal, a modern machine park and a research-measurement park. Own transport, developed logistics network, a spacious warehouse (ultimately 6500 pallet places) allow us to complete both "ad-hoc" and customized orders efficiently.

Specialized service

We believe that accessible and flexible support is the thing that makes a difference between standard delivery of goods and delivery of solutions. Our team of salesmen is at disposal through all project's phases, serving with reliable support. We provide required documentation, certificates and additional tests. We treat each client's project individually. We are well-known for using our knowledge and qualifications, we suggest our clients solutions that are the best and most effective in terms of costs.

A dedicated company that distributes and trade with pipeline elements:

- » steel flanges
- » pipe fittings
- » steel pipes.

We offer products in all available material groups, we specialize in a range of gas steel P355NH, L360NB, L415NB, L485MB as well as the ferritic alloy steel, that is pipeline elements in grades: 16Mo3, 13CrMo4-5, 10CrMo9-10, X10CrMo V Nb9-1.



Steel flanges

We offer neck flanges, blind flanges, slip-on flanges, lap-joint flanges:

- » for pipeline connections in the scope of DN10- DN2500
- » according to implementing standards:
 - » EN 1092-1 for PN2,5-PN400
 - » DN2631 : DIN2627
 - » ASME B16.5 for 150-2500 LBS
 - » ASME B16.47 A and B series for 150-900 LBS

Pipe fittings

We offer elbows, tees, reducers, head caps, side bends:

- » for pipeline connections in the scope of DN15-2500
- » according to the implementing standards:
 - » EN 10253-2 of A and B type
 - » DIN 2605 part 1 and 2
 - » DIN 2615 part 1 and 2
 - » DIN 2616 part 1 and 2
 - » ASME B16.9 for diameters $\frac{1}{2}$ " – 48"
 - » KER (customized dimensions)
 - » API 6A
 - » EN 13480
 - » EN 14870

We offer also elements made in accordance with a technical drawing and forged fittings according to the following norms:

- » ASME B16.11 for diameters $\frac{1}{2}$ " – 4"
- » MSS SP 97 for diameters $\frac{1}{2}$ " – 8"



Steel pipes

We offer a wide range of proven high quality steel pipes for use in construction of industrial pipe-line, reduction stations and pumping stations, including tubes:

- » seamless line pipes suitable for flammable media in accordance with ISO 3183
- » longitudinally or spirally welded pipes (SAWL and SAWH) suitable for flammable media in accordance with ISO 3183
- » line pipes suitable for flammable media with anticorrosive coating according to DIN 30670 or ISO 21809-1
- » welded and seamless line pipes in accordance with EN 10217-1, EN 10217-2 and EN 10217-5
- » welded and seamless carbon steel pipes high temperatures in accordance with EN 10216-2, EN 10217-2 and EN 10217-5
- » seamless ferritic alloy steel pipes for high temperatures in accordance with EN 10216-2
- » welded and seamless high-pressure pipes for low temperatures in accordance with EN 10216-4, EN 10217-3 and EN 10217-5



We provide additional services on our customers' demands, among others:

- » laboratory examinations
- » acceptances 3.2
- » hot applied PUR anticorrosive coating in accordance with PN EN 10290 type B
- » additional mechanical processing, e.g. chamfering, welding, threading
- » internal and external painting (e.g. in acc. with API RP 5L2)
- » pipe bending into bends in accordance with a technical drawing and provided specification, according to the EN 13480 and EN 14870 norms

www.metkom.com.pl



A dedicated company that produces pipeline elements in the scope of diameters DN15–DN1200 of carbon, high-alloyed and stainless steel. The modern machine park includes e.g. CNC Hyundai Wia LV-800RM and Maktek CH7120B lathes. In the research-measurement park there are, among others Olympus – EPOCH ultrasonic defectoscope. We offer welding with the TIG, MAG/MIG methods as well as shaping with turning diameter to 200mm and 2500 mm length. High quality of production and provided services is confirmed with the implemented Quality Management System in accordance with ISO 9001:2008 standard as well as quality certificates in welding, in accordance with EN ISO 3834–2:2007 standard and AD 2000-Merkblatt HPO and AD 2000-Merkblatt W0.

A scope of production:

- » flanged pipes
- » flanged fitting
- » neck and slip-on flanges
- » expansion joints
- » tees and segment elbows
- » bracket and hanger elements
- » industrial fittings and fixtures (valves, bolts, throttles etc.)
- » pump suction strainers
- » ZNO ventilation valves
- » elements customized according to client's technical specification
- » prefabrication (with completion of fittings) of reduction stations; pressure tests on request

Welding:

- » we perform containers, welded pipeline elements as well as constructions, both made of carbon and stainless steel
- » we have the following welding methods:
 - » arc welding be carried out using welding electrode in the MIG inert gas shield
 - » arc welding in MAG gas chemically active shield
 - » arc welding be carried out using non-welding electrode in the TIG inert gas shield

We constantly increase the scope of our production. Based on customer demand, we perform also services in the field of processing:

Machining:

- » turning elements of up to 1200mm diameter and 2500mm long
- » components tooling on horizontal and vertical milling machines
- » drilling holes with use of column and radial drilling machines
- » threading

Forming processes:

- » CNC plasma cutting of steel up to 40mm thick
- » CNC oxygen cutting up to 160mm thick with dimensions of 2000x6000mm
- » DN1200 pipes cutting system enables also cutting out any curve and holes in pipes with their mutual transfer
- » folding metal sheets of 2mm to 45mm thick
- » bending of pipes with use of hydraulic benders
- » sawing on the bandsaws (scope of 600x800mm)



Pipeline elements - **high quality production**

www.sw-armatura.pl

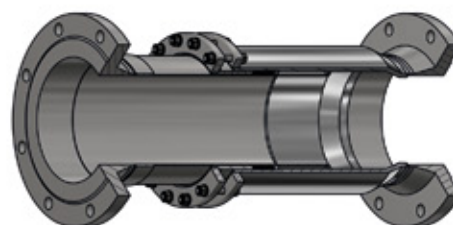
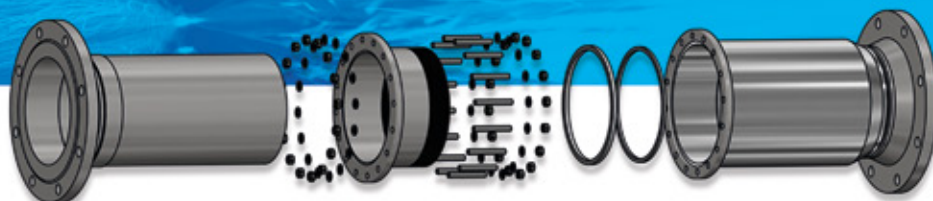
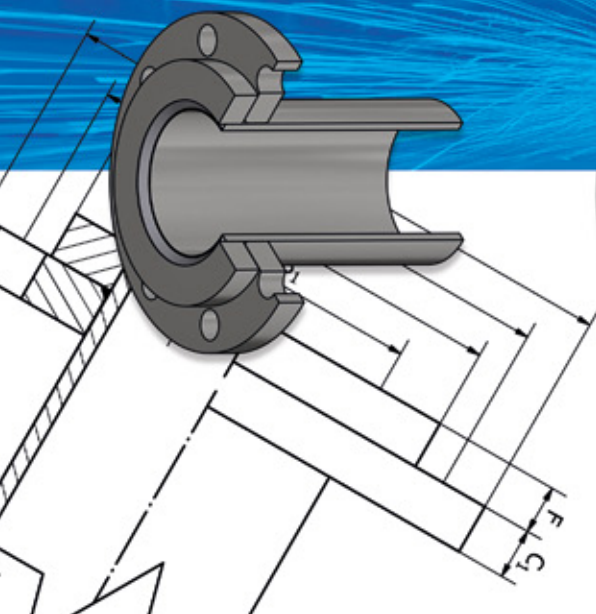

**A dedicated company specialized in the sale of industrial fittings.
We stand out due to:**

- » a wide range of products
- » individual and qualified technical consultation
- » high quality of products
- » direct import of fittings from the entire world
- » own production offered under two brands – SW and GTM
- » advantageous trading conditions
- » short leading times

We offer fittings of carbon cast steel, acid-resistant cast steel and cast iron, according to the EN and ANSI standards. Our specialist consultancy and advantageous trading conditions cause that the GTM Process Valves products are used in the largest companies from chemical, petrochemical, mining and energy industries in Poland.



www.gtm-pv.pl

**Specialized in production
and distribution of industrial
fittings**

The offered products:

- » throttles
- » ball valves
- » gate and knife gate valves
- » globe valves
- » solenoid valves
- » check valves
- » strainers and sight glasses
- » pressure reducing valves and steam traps
- » needle and manometric valves
- » control-measurement equipment

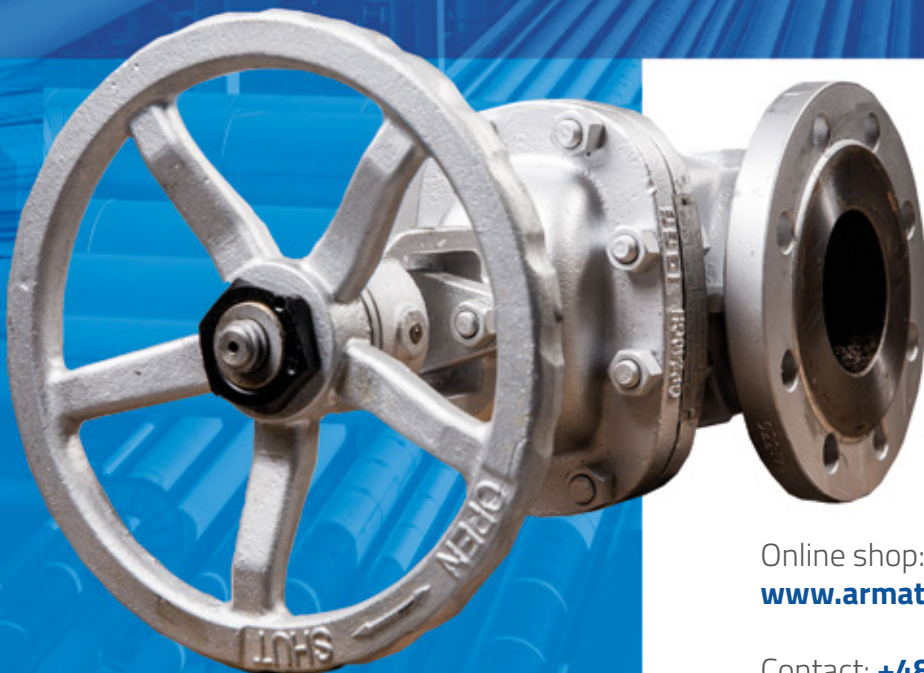

A detailed offer
available at:
www.gtm-pv.pl

Online shop:
www.armatura-przemyslowa.com.pl

Contact: **+48 61 652 91 32** or gtm@gtm-pv.pl

**PW METKOM SPÓŁKA Z OGRANICZONĄ
ODPOWIEDZIALNOŚCIĄ SPÓŁKA KOMANDYTOWA**

ul. Gajowa 17, 43-254 Warszowice, Poland
NIP: 6381808706, REGON: 243419340

tel.: +48 /32/ 462 33 00
tel.: +48 504 220 383
fax: +48 /32/ 462 33 02
www.grupametkom.pl

Office and Company Board

tel.: +48 /32/ 462 33 00
fax: +48 /32/ 462 33 02
e-mail: biuro@metkom.com.pl



Sales Department

Offers, inquiries

tel.: +48 /32/ 462 33 20
GSM: +48 505 053 771
e-mail: zapytania@metkom.com.pl

Steel Pipes Team

tel.: +48 /32/ 462 33 61
GSM: +48 695 850 456
e-mail: rury@metkom.com.pl

Poznań Division

ul. Naramowicka 68, 61-619 Poznań



GTM Process Valves Sp. z o.o.

ul. Naramowicka 68, 61-619 Poznań

tel. +48 61 652 91 32
fax +48 61 641 75 91
tel. GSM +48 603 12 45 10
www.gtm-pv.pl

Export Department

tel.: +48 /32/ 462 33 33
GSM: +48 603 127 060
e-mail: export@metkom.com.pl

Representation Office - Slovakia

ul. Hlavna 2187/73 A, 927-01 Sala
tel: +421 903 585 444
e-mail: office_slovakia@metkom.com.pl



SW-Armatura Sp. z o.o.

ul. Gajowa 17, 43-254 Warszowice

tel.: +48 /32/ 462 33 00
fax: +48 /32/ 462 33 02
www.sw-armatura.pl

