



OKNA
www.amokna.net



PVC and aluminium systems

About the company

AM OKNA creates more than just perfect windows and doors it creates a better view of the future.



AM OKNA is a family brand, which was established 2005 in Poland. From the very beginning, we have been winning the trust of the Polish, as well as foreign customers.

The main area of our activity involves manufacturing high-quality awindows and doors aluminium and PVC constructions. The extensive offer includes products such as: window accessories, external roller blinds, facade shutters, garage doors, external doors and SmartHome (SmartDom) integrated systems.

We focus on continuous improvement of our employees' competences, along with constantly improved quality of our products and services.

As a result of these decisions, a part of the production plant has been moved to a new hall and equipped with a fully automated machining center, with top-quality welding machines.

The company's efforts are appreciated on foreign markets with major export destination in whole europe and north america. The constantly increasing export share provide worldwide solutions depending on the market

10

major export destinations

80%

of goods are exported

220

fittings with glass windows per day

17

years on the market

SoftLine 82

New generation
energy-efficient system.



Carefully designed construction of VEKA SoftLine 82 profiles allows to achieve extremely low heat transfer coefficient. This significantly reduces energy consumption and saves heating costs. A triple gasket system effectively protects against draughts and cold penetration.

A few dozen colour options in combination with reproduction of wood or aluminium finishes give designers full freedom of action, all the more so as the construction finish does not have to be the same on the inside and outside.

0,7

U_g (W/m²K) for the
glazing package
 $U_g = 0.4$ W/m²K

0,91

U_w (W/m²K) for the
glazing package
 $U_w = 0.7$ W/m²K

7/6

chambers
(frame/sash)

3

gaskets

82

installation depth
(mm)

A

class

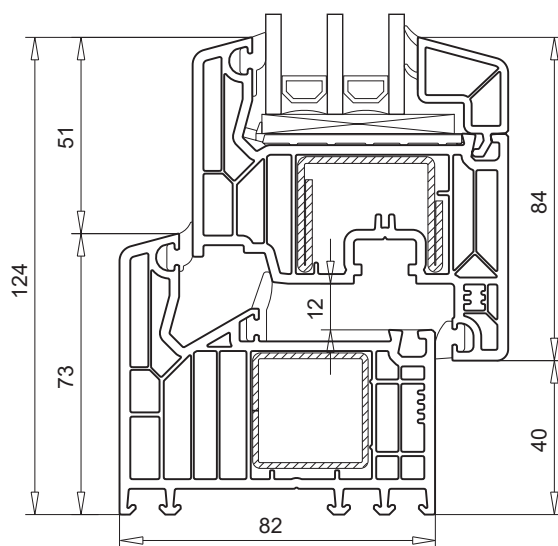

PerfectLine 70

Excellent quality profiles with excellent thermal insulation.



System Perfectline 70 characterized by 5 chambers in the frame and 5 chambers in the sash with an installation profile depth of 70 mm is created to provide heat insulation at a high level. A system of two external gaskets ensures good

tightness, acoustic insulation. Gasket surfaces with a 15 degree gradient enable very good drainage of water and dirt.

1,1

U_w (W/m²K) for the glazing package
 $U_g = 1,0$ W/m²K

5/5

chambers
(frame/sash)

2

gaskets

70

installation depth
(mm)

A

class

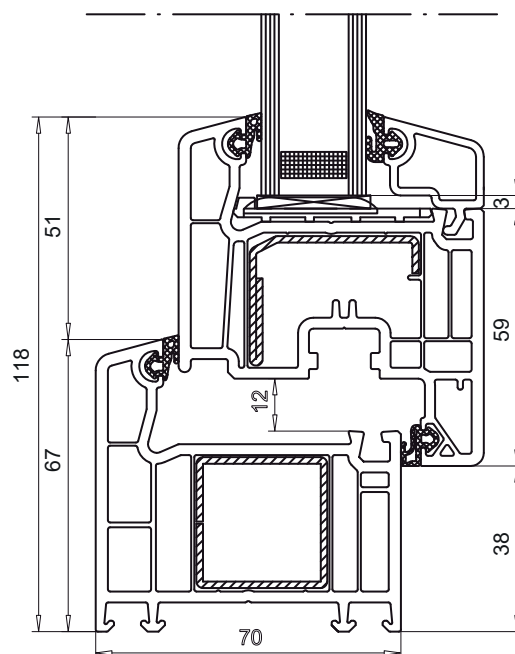

VEKAMOTION 82

New lift and slide door system with excellent performance and ease of use.



Modern construction appreciates large glazing, allowing the construction of sliding doors that blend the interior of the house into its surroundings in an impressive way. A living room in a garden or a garden in a living room? With systems such as **VEKAMOTION**, the permeation of these spaces is absolutely possible.

The new system, based on modern technologies, allows to construct large doors, even up to **6.5 m wide and 2.5 m high**. **VEKAMOTION** also means excellent thermal insulation of sections and a possibility to install triple glazing in them, up to 54 mm thick. The latest generation of warm threshold provides the possibility of threshold-less installation, while the design of the fixed sash blends in perfectly with the facade of the building, thanks to its unique construction that allows it to be installed almost frameless.

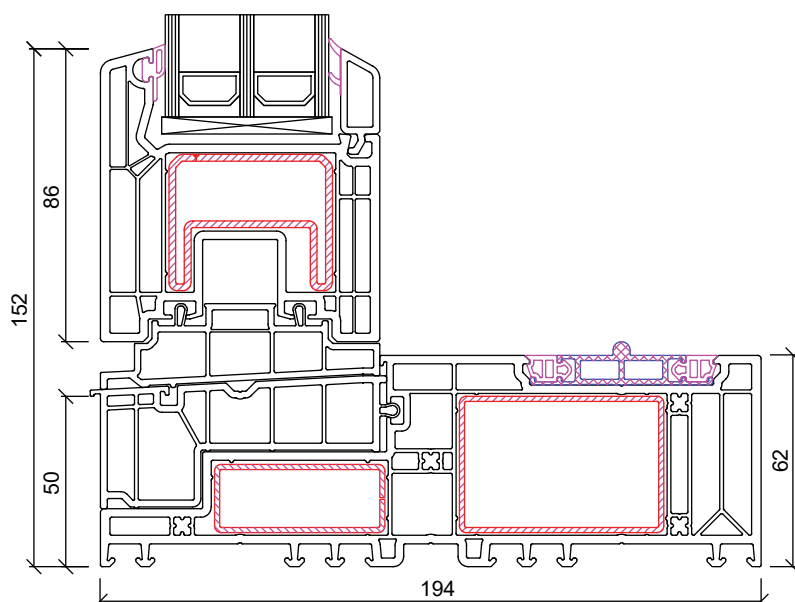

Smart-Slide door

New generation
of sliding patio doors.



Smart-Slide doors are a new solution in the sliding segment, which may ultimately be an attractive alternative to HST doors. It is a perfect solution for family houses, where straightforward operation and reliability are expected.

A clever combination of technical solutions makes the Smart-Slide achieve particularly good results in air permeability, wind pressure resistance and water tightness tests. All this thanks to properly fitted gaskets that are pressed transversely to the frame, along the entire circumference.

The innovative closing mechanism allows for simple and intuitive operation.

Specialized fittings guarantee that the sash, after its unblocking, moves on bogies freely and without the slightest resistance in relation to the unopened part of the structure. The locking mechanism allows the sash to close gently in the frame, thus making the sliding door easy to operate.

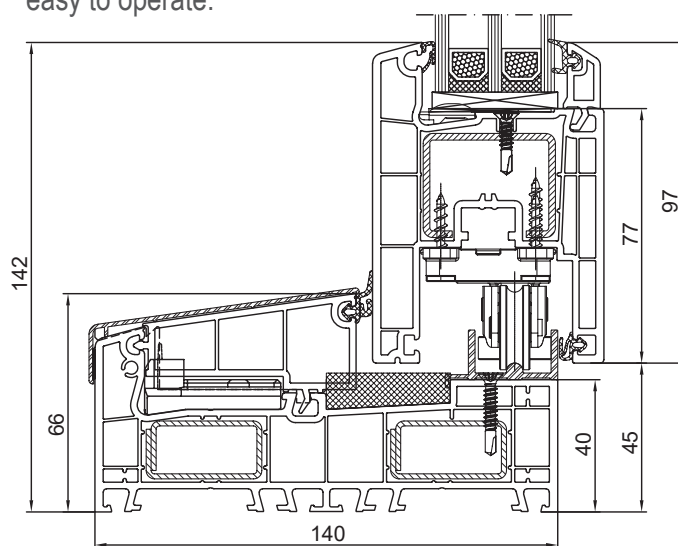

Superial I+

Three-chamber windows and doors system with increased thermal insulation.



Profile system designed to create windows, doors and storefronts with high thermal insulation parameters (U_f from 1.08 W/m²K).

Excellent coefficients are obtained through the use of special slip-in thermal insulation between the thermal separators and around the glass; these enable to improve profile insulation. The system allows to design modern window solutions in a number of options. It is used in design housing and utility public buildings.

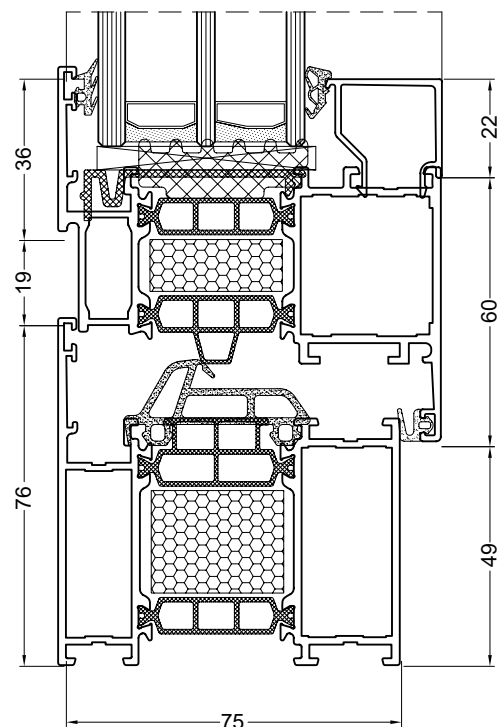

75

installation depth
(mm)

84

sash depth
(mm)

**Thermal
break**

Genesis 75

Three-chamber windows and doors system with additional thermal seal.



Genesis aluminium system designed for windows and doors with increased thermal insulation (U_f from 0.84 Wm^2K). This three chambers profile uses modern thermal break solution, which are currently a novelty on the market. Apart from the classic central window gasket, an additional thermal seal was designed, as a result of which a very high tightness was obtained (air infiltration, watertightness) along with an innovative appearance and aesthetics.

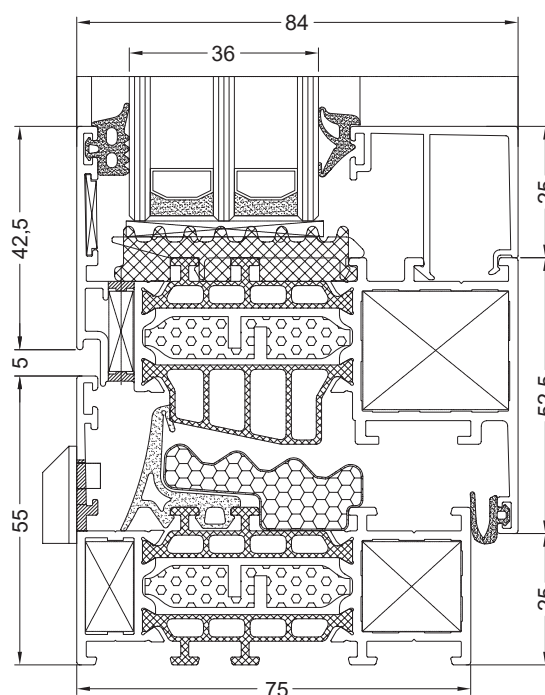

75

installation depth
(mm)

84

sash depth
(mm)

**Thermal
break**

Imperial I+

Windows and doors system with thermal insulation.



The **Imperial I+** profile system features good insulation parameters (U_f from $1.28 \text{ W/m}^2\text{K}$). High thermal insulation parameters are obtained by using special thermal inserts between the thermal separators and around the glass pane. This system allows for the use of all common types of single-, double-chamber, acoustic or anti-burglary glass despite the profile installation depth of only 65 mm.

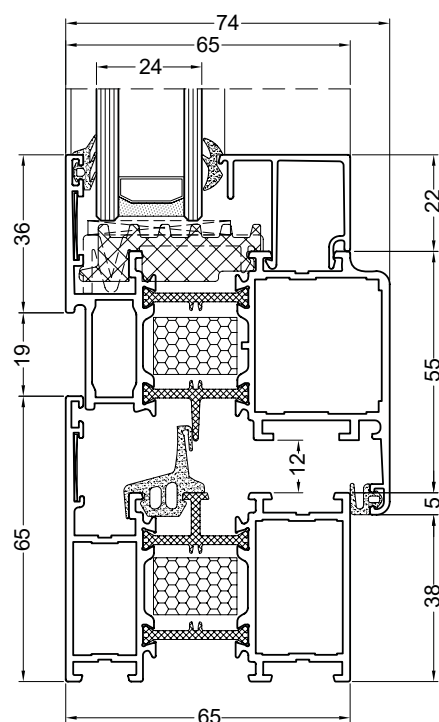

65

installation depth
(mm)

74

sash depth
(mm)

**Center
gasket**

ULTRAGLIDE system

Aluminum sliding constructions with excellent performance.



The **ULTRAGLIDE** system meets the current standards in the field of safety, thermal insulation, and aesthetics. Great parameters of the **ULTRAGLIDE** system allow to design large constructions even up to 16 meters width with maximum achievable dimensions of sash height 3300 mm and sash width - 3500 mm (max sash weight 250 kg for the sliding option, and 400 kg for the lift-and-slide option). This system allows your imagination to come true about the largest sliding doors.

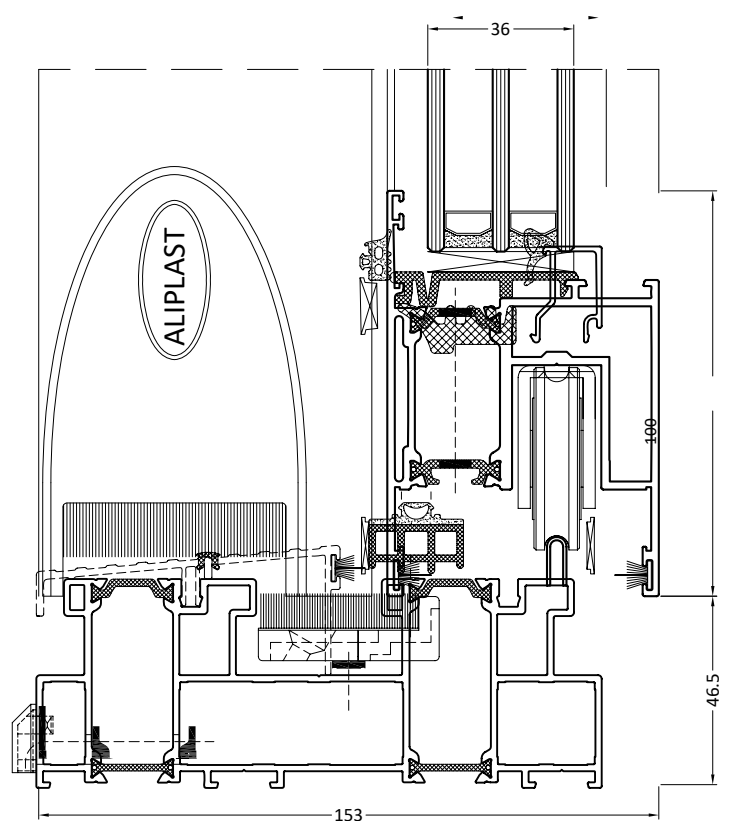
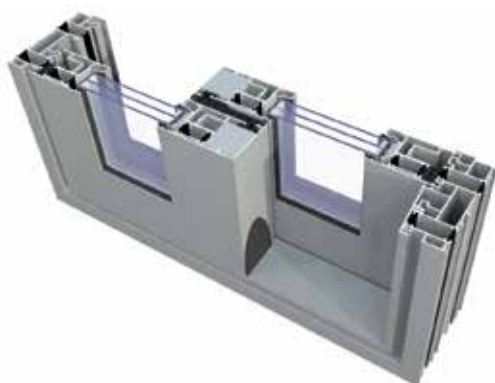

Folding doors

Open up to your garden with folding accordion systems.



Aliplast folding doors system named **Panorama** is designed to enable the arrangement of wide and open passages. Depending on requirements and the application the Panorama systems offers inswing or outswing sashes and offer the possibility to create constructions up even to 8 meters wide.

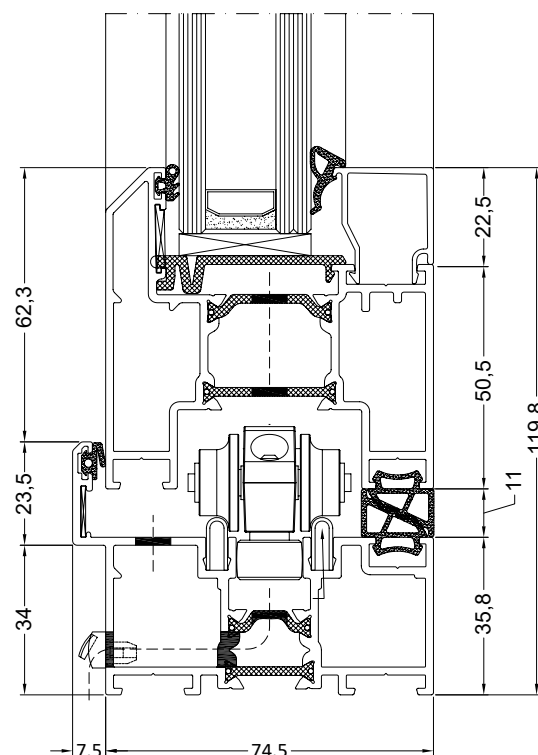
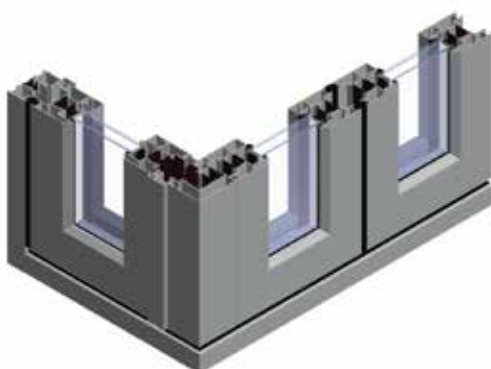



AM Okna will provide you with a wide range of roller blinds and accessories: www.amokna.net

Authorised representative of AM OKNA company

AM OKNA
ul. Podmiejska 21 A
66-400 Gorzów Wielkopolski
Poland

info@amokna.eu
www.amokna.net

www.facebook.com/AM.OKNA.am.windows