



SAUDI HEALTH

8-10 MAY 2017

Riyadh International Convention &amp; Exhibition Center - RICEC

Reserve the best available space... Reply now for Priority Attention!

Tel: +966 11 2295604 • Fax: +966 11 2295612 • E-mail: info@recexpo.com

**OPTION 1**

Inside Space Only (Minimum Space - 21 sqm.)

**US\$ 440 per m<sup>2</sup>**

Power supply is charged separately.

**Space & Standfitting requirements:**

Please choose one:

Space Type	Cost	Size	Total
Option 1	US\$ 440 / m <sup>2</sup>	m	
Option 2	US\$ 495 / m <sup>2</sup>	m	

**OPTION 2**

Inside Space with Standard

Package (Minimum Space - 9 sqm.)

**US\$ 495 per m<sup>2</sup>**

Perspective View

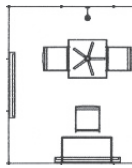

- 3 spot lights
- 1 Power outlet
- 1 Counter
- 2 Chairs
- 1 Table
- Fascia name board

Name \_\_\_\_\_

Job Title \_\_\_\_\_

Company \_\_\_\_\_

Address \_\_\_\_\_

Country \_\_\_\_\_

Tel. \_\_\_\_\_

Fax \_\_\_\_\_

E-mail \_\_\_\_\_

Website \_\_\_\_\_

Product / Activity \_\_\_\_\_

Date \_\_\_\_\_

Signature \_\_\_\_\_

Fax your Space Option Form to your Country Coordinator or the Organizers

**NOEL PUNO****International Sales Manager  
Riyadh Exhibitions Co. Ltd.**P.O. Box 56010, Riyadh 11554, Saudi Arabia  
Tel. +966 11 229 5604 ext. 509 • Fax +966 11 229 5612  
Mobile : +966 507 850 383  
E-mail: noel.puno@recexpo.com

Under the Patronage of